

## PAPER MACHINE GAUGE

- Hinged Ring Chrome Plated Steel Case
- Protective Weather Tight Seal
- Restrictor is Standard

Marsh Instruments Paper Machine Gauges are available in nine ranges and fit existing panel cutouts. The heavy-duty case features a front flanged/ hinged ring design which allows easy access to a weephole that prevents condensation buildup. A restrictor is standard. The Marsh Paper Machine Gauge is available in 3½" size only. Each gauge has a weather-tight seal to protect against dust and atmospheric contaminants.

Marsh Instruments Paper Machine gauges are specifically designed to meet the demands of the pulp and paper industry.

### SPECIFICATIONS

#### ACCURACY

ASME Grade A - ± 2/1/2% (± 1% of range across middle half of scale)

#### CASE SIZES

3½" diameter

#### CASE MATERIAL

Stainless Steel

#### CASE STYLE

LBM - Lower Back Mount

#### TUBE & SOCKET

Copper alloy

#### MOVEMENT

Stainless Steel

#### CONNECTION

¼ NPT

#### RANGES

30 to 1,000 psi

#### DIAL STANDARD

Single scale psi

#### DIAL COLOR

Black markings on white

#### POINTER

Aluminum, black painted

#### WINDOW

Glass lens, chrome plated brass ring with weather-tight seal

#### RESTRICTOR

Standard

#### WEIGHT

1.0 lb

### STANDARD RANGES & PART NUMBERS

TYPE	PAPER MACHINE GAUGES
Size	3½"
Case Material	Steel, Chrome Plated
Internals	Copper Alloy
Mounting / Case Style	LBM
Connection	¼ NPT
Scale Standard	psi
0 to 30 psi	W6042
0 to 60 psi	W6046
0 to 100 psi	W6048
0 to 160 psi	W6052
0 to 200 psi	W6054
0 to 300 psi	W6058
0 to 400 psi	W6060
0 to 600 psi	W6064
0 to 1,000 psi	W6072

### PAPER MACHINE GAUGE OPTIONS

OPTION	TYPE	SUFFIX	AVAILABLE ON MODELS
Restrictor	Special Restrictor	H	
	No restrictor	H1	
Catalog Dials	bar only	L1	See Marsh Price List for minimum
	kg/cm <sup>2</sup> only	L2	
	kPa only	L3	
	MPa only	L4	
	psi & bar	W1	
	psi & kg/cm <sup>2</sup>	W2	
	psi & kPa	W3	
	psi & MPa	W4	
Custom Dials	Logo or custom face	M	Consult factory for colors and minimums

### PAPER MACHINE GAUGE DIMENSIONS

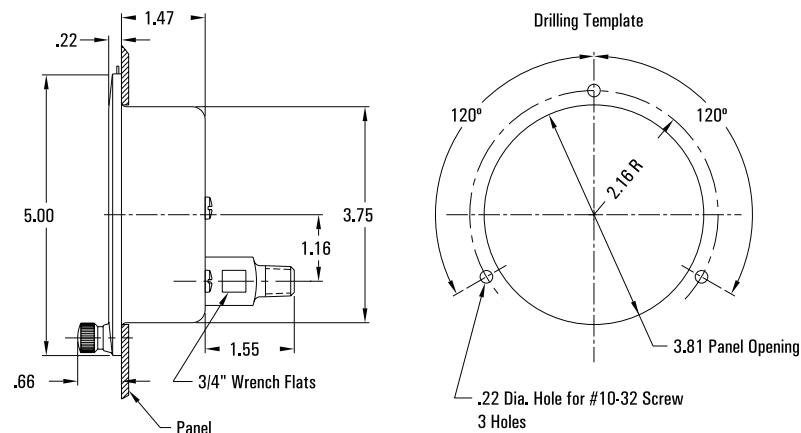

PART#	DESCRIPTION
<b>GAUGE COCK AND SIPHONS</b>	
111025	¼" F x ¼"F Brass Gauge Cock (T-Handle #123)
111028	¼" M union x ¼" F Brass Gauge Cock (Lever Handle #125)
111029	¼"M x ¼"M Steel Straight Siphon (600psi @ 400°F)
111030	¼"M x ¼"M Brass Straight Siphon (250psi @ 400°F)
111031	¼"M x ¼"M Steel Angle Type Siphon (600psi @ 400°F)
111032	¼"M x ¼"M Brass Angle Type Siphon (250psi @ 400°F)
<b>CLEARLOK (ACRYLIC) CONVEX WINDOW INTERNAL THREAD "G" Series Fig. 83 Diaphragm Gauges</b>	
124602	2½" for 83K & 83KC
127985	2½" for 83KB & 83KD
125448-001	3½" for all models (knurled edge)
<b>CLEARLOK (ACRYLIC) WINDOWS (INTERNAL THREAD) "J" SERIES</b>	
W15CL	1½" for LM or CB
W20CL	2" for LM or CB
W20CLUC	2" for U-Clamp or Front Flange
W25CL	2½" for LM or CB
W25CLUC	2½" for U-Clamp or Front Flange
W35CL	3½" for LM or CB
W35CLUC	3½" for U-Clamp or Front Flange
<b>RESTRICTOR SCREWS ¼" &amp; ½" NPT Threaded Brass 8-40</b>	
100116-008	AIR (.008)
100116-013	WATER (.013)
100116-016	OIL (.016)
<b>RESTRICTOR SCREWS LARGE DIAL (D, E, H, &amp; P) ¼" &amp; ½" NPT Threaded Brass M5 X 0.8</b>	
RES008BRLD	AIR (.008)
RES013BRLD	WATER (.013)
RES016BRLD	OIL (.016)
<b>RESTRICTOR SCREWS LARGE DIAL (D, E, H, &amp; P) ¼" &amp; ½" NPT Threaded 316 SST M5 X 0.8</b>	
RES018SSLD	All Apps. (.018)
<b>RESTRICTOR SCREWS GENERAL SERVICE (J)</b>	
150139-013	Air (.013)
150139-018	"Standard" (.018)
150139-025	Water (.025)
150139-040	Oil (.040)
<b>RESTRICTOR SCREWS SEVERE SERVICE SERIES (J &amp; X) ⅛", ¼" &amp; ½" NPT Push-In Brass</b>	
RES018PB	"Standard" (.018)
RES013PB	AIR (.013)
RES025PB	WATER (.025)
RES040PB	OIL (.040)
<b>RESTRICTOR SCREWS SEVERE SERVICE SERIES J &amp; X ⅛", ¼" &amp; ½" Push-In 316 SST</b>	
RES018PBSS	"Standard" (.018)

PART#	DESCRIPTION
<b>FRONT FLANGE (3-HOLE) CASE &amp; WINDOW ASS'Y FOR BACK CONNECT (CB) "J" Series Gauge</b>	
CS25FF	2½" Front Flange Case
W25CLUC	2½" Window Assembly
CS35FF	3½" Front Flange Case
W35CLUC	3½" Window Assembly
<b>LIQUID FILL CONVERSION KIT</b>	
127656	Silicone, 1000 cc, 1 quart
133426	Glycerine, 1 quart
<b>HAND JACK &amp; DUPLEX HAND JACK</b>	
110983	Duplex Hand Jack/Driver Set
110985	Hand Jack (Pointer Remover)
<b>ADJUSTABLE (SLOTTED) POINTER</b>	
PTR20ADJ-B	Adjustable Pointer - 2"
PTR25ADJ-B	Adjustable Pointer - 2½"
PTR35ADJ-B	Adjustable Pointer - 3½"
PTR45ADJ-B	Adjustable Pointer - 4½"
<b>MICROMETER POINTER, LARGE DIAL SERIES</b>	
PTRP45	4½" Dial (D, H & P)
PTRP60	6" Dial (D, H & P)

PART#	DESCRIPTION
<b>SEVERE SERVICE GAUGE ACCESSORIES</b>	
127794	Adapter ring, 63mm to 2½"
Flange63	Front Flange for 63mm: C Case
133279	Front Flange for 63mm: CB or UC case (no holes)
Flange100	Front Flange for 100mm: C Case
<b>CERTIFICATION FORMS</b>	
134476	Material Certification
134477	Certificate of Conformance
134478	Certificate of Compliance
134479	Certificate of Origin
134480	Certificate of Calibration
134481	Certificate of Accuracy

PART#	DESCRIPTION	MEDIA	MAX PRESSURES
<b>INDUSTRIAL PRESSURE SNUBBERS</b>			
S20BD	¼ NPT, Brass	Heavy Oil	5,000 psi
S20BE	¼ NPT, Brass	Water & Light Oil	5,000 psi
S20BG	¼ NPT, Brass	Air & Gases	5,000 psi
S20SD	¼ NPT, 303SS	Heavy Oil	15,000 psi
S20SE	¼ NPT, 303SS	Water & Light Oil	15,000 psi
S20SG	¼ NPT, 303SS	Air & Gases	15,000 psi
S40BD	½ NPT, Brass	Heavy Oil	5,000 psi
S40BE	½ NPT, Brass	Water & Light Oil	5,000 psi
S40BG	½ NPT, Brass	Air & Gases	5,000 psi
S40SD	½ NPT, 303SS	Heavy Oil	15,000 psi
S40SE	½ NPT, 303SS	Water & Light Oil	15,000 psi
S40SG	½ NPT, 303SS	Air & Gases	15,000 psi